

HVLS - HIGH VOLUMN LOW SPEED FAN : WOOD TRUSS MOUNT

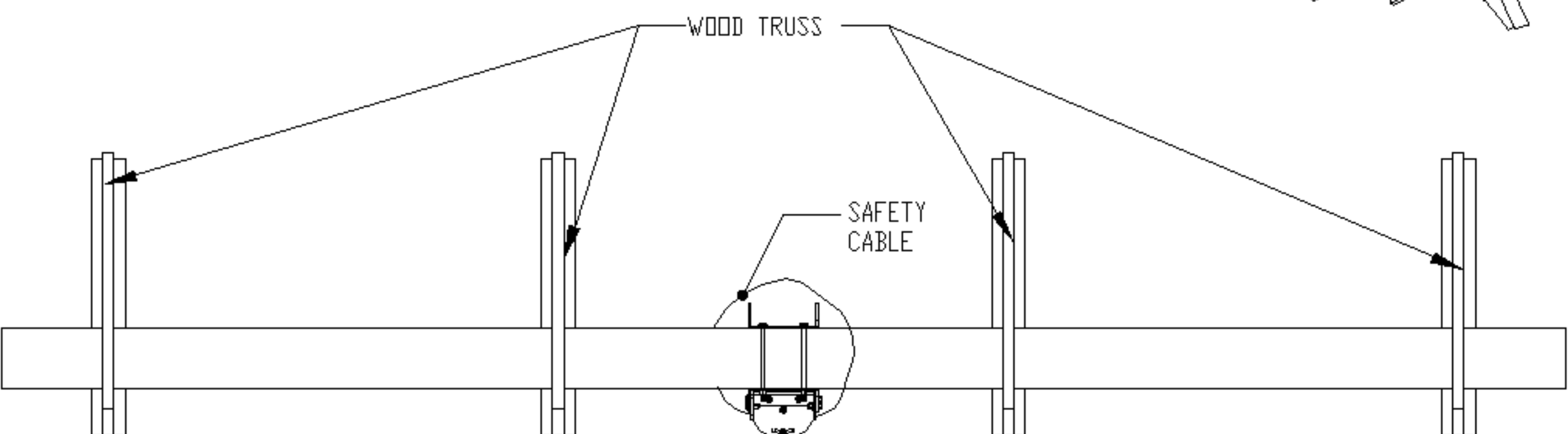
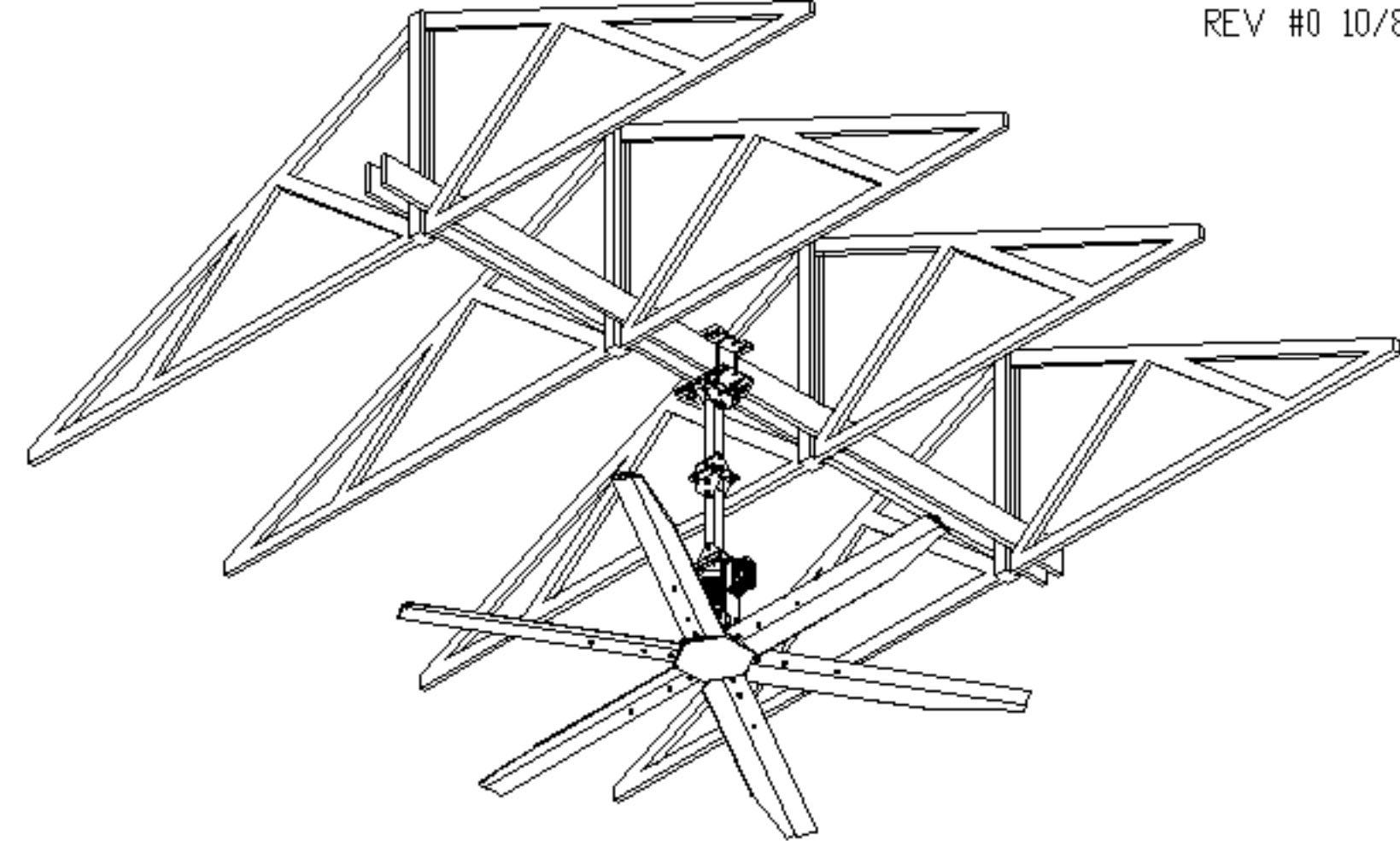

OPTIONAL EXTENSION  
(AVAILABLE IN 2', 4', 6'  
& 8' LENGTHS) MAX 2  
PER FAN

SAFETY  
CABLE

STANDARD PIVOT MOUNT  
(AVAILABLE IN 1', 2' OR 4'  
LENGTHS)

SECURE TO  
ROOFING MEMBER

FAN MOUNTED  
VFD (OPTIONAL)

MAIN HUB  
AND DRIVE  
ASSEMBLY

GUY WIRE (4)

CLEARANCES :

- 60" MIN CENTER OF FAN TO ROOF DECK
- 30" MIN FROM FAN BLADE'S LEADING EDGE TO OBSTRUCTIONS ABOVE OR BELOW
- 18" MIN FROM SIDE OF FAN TO ANY OBSTRUCTION
- 144" MIN FROM FLOOR TO FAN LEADING EDGE HEIGHT

45°-60°

25  
21 1/2

FAN BLADES 6', 8', 10', 12', 14', 16', 18', 20', 22' & 24'