

MODEL 76 INDOOR DOWN DISCHARGE DIRECT FIRED HEATER WITH FILTER

VBD/60AH  
REV#5 07/28/2016



Direct Fired Profile Plate Specifications:

**Description:**  
Direct fired burners shall have patented (US Patent No. US6629523B2), self-adjusting profile plates designed to ensure proper air velocity and pressure drop across the burner. Profile plates shall adjust to compensate for burner misalignment, burner wear, and burner levels to a maximum of 30ppm of carbon monoxide (CO), and 150ppm of nitrogen dioxide (NO2).

**Application:**  
Spring-loaded burner profile plates are engineered to automatically react to the momentum of combustion gases, without the need for any motion of actuators or mechanical adjusters. With this feature, all DF units are designed for demand control ventilation (DCV) requirements.

**Certifications:**  
All profile plate assemblies shall be included in the DF unit's ETL listing and comply with combine safety standards ANSI Z83.4 and CSA 3.7 (non-recirculating DF heaters) and ANSI Z83.18 (recirculating DF heaters).

**General Construction:**  
-Profile plates shall be formed from G90 galvanized steel.  
-Profile plates shall vary in size per unit.  
-Profile plates shall be mounted along the same plane as the discharge of the burner.  
-Design shall incorporate properly torqued, permanently mounted spring hinges.

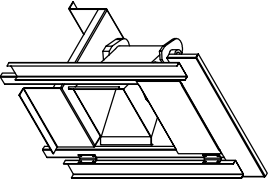
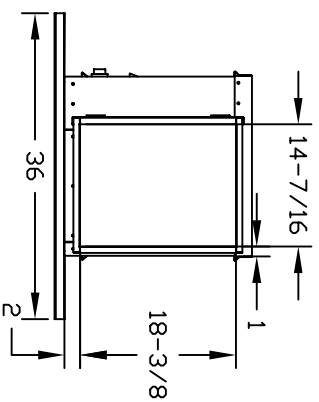
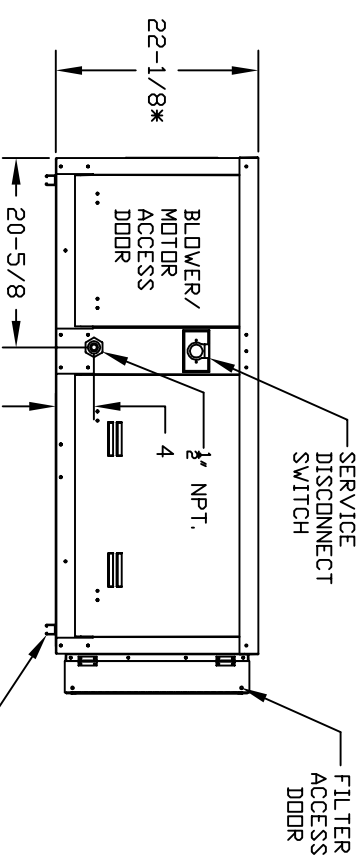
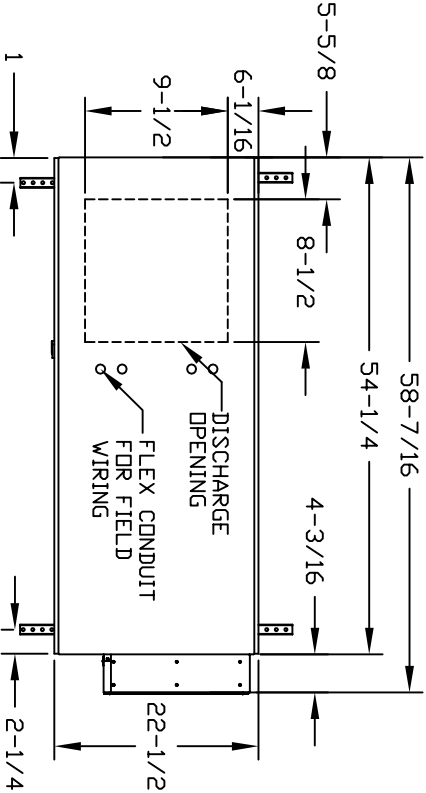

Direct Fired (DF) Profile Plate Assembly

UNIT INFORMATION

MODEL	WEIGHT	BTU RANGE (MBH)		GAS PRESSURE		CFM RANGE		FILTERS	
		BURNER LENGTH	BTU LOW	BTU HIGH	MIN	MAX	MIN	MAX	FILTER SIZE & QTY
76	315 Lbs	6'	18	225000	5" WC	14" WC	600	1600	16"x20"x2" (1)

ALL DIMENSIONS ARE NOMINAL AND GIVEN IN INCHES.  
\*ADN 2 INCHES THRU THIRTEENTH IF LISTED UNLESS OTHERWISE NOTED.