

MODULAR OUTDOOR DOWN DISCHARGE DIRECT FIRED HEATER-ROOF TOP PACKAGE WITH V-BANK, LPD EVAPORATIVE COOLER AND SCREEN INTAKE

SIVLPCB2B4HRT
REV#3 05/05/20

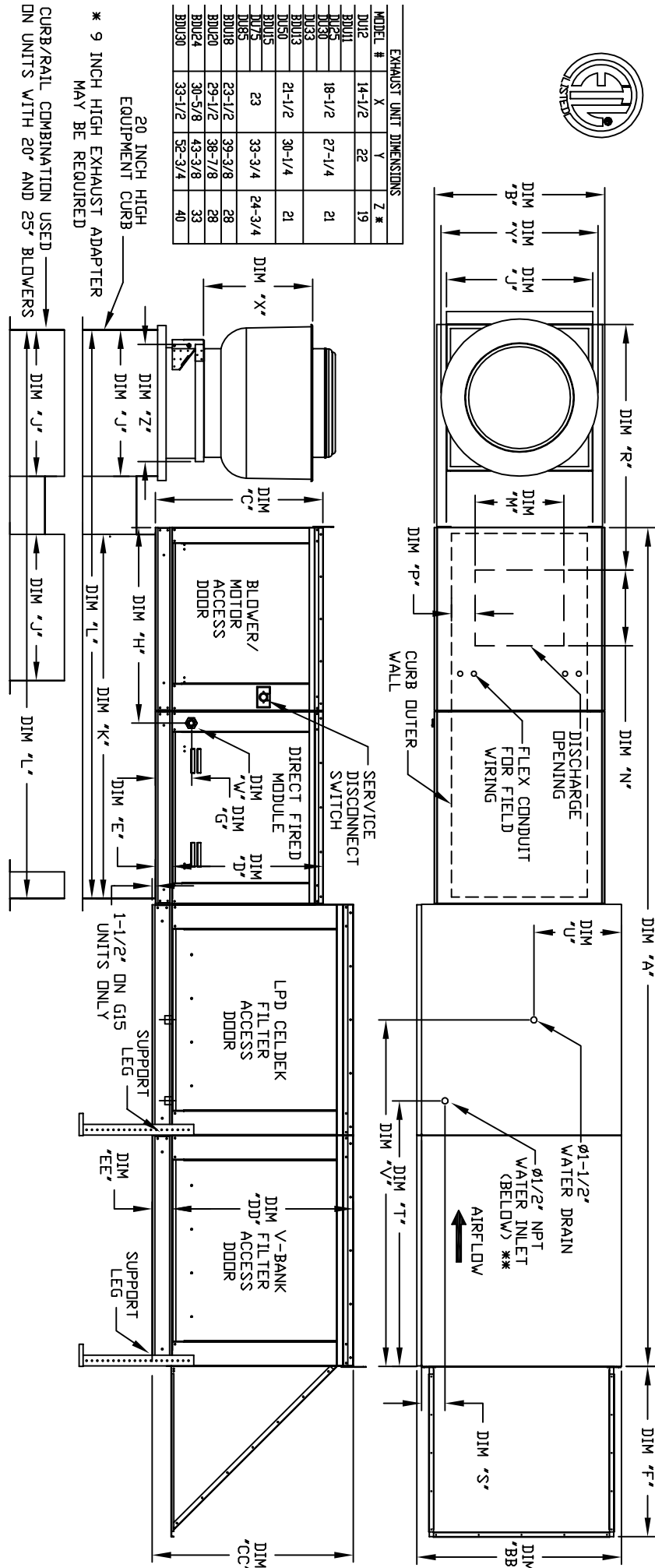

EXHAUST UNIT DIMENSIONS

| MODEL # | X | Y | Z * |
|---------|--------|--------|--------|
| BDU1 | 14-1/2 | 22 | 19 |
| BDU2 | 18-1/2 | 27-1/4 | 21 |
| BDU3 | 21-1/2 | 30-1/4 | 21 |
| BDU4 | 23 | 33-3/4 | 24-3/4 |
| BDU5 | 23-1/2 | 39-3/8 | 28 |
| BDU6 | 29-1/2 | 38-7/8 | 33 |
| BDU7 | 30-5/8 | 43-3/8 | 33 |
| BDU8 | 33-1/2 | 52-3/4 | 40 |

ALL DIMENSIONS ARE NOMINAL AND GIVEN IN INCHES.

| MODEL | BURNER | | | GAS PRESSURE | | | GAS CONNECTION | | | UNIT DIMENSIONS | | | CURB | | | DISCHARGE OPENING | | | WATER INLET | | | DRAIN OPENING | | |
|----------|---------|---------|--------|--------------|--------|--------|----------------|-------|-------|-----------------|---------|----------|------|----------|----------|-------------------|--------|--------|-------------|-------|--------|---------------|--------|----|
| | A | B | BB | CC | D | DD | EE | FF | GG | HH | II | JJ | KK | LL | MM | NN | OO | PP | QQ | RR | SS | TT | UU | VV |
| D250-G10 | 138-7/8 | 27-3/8 | 36-3/4 | 29-3/4 | 36-3/4 | 26-1/8 | 33 | 3-3/4 | 3-3/4 | 30-5/16 | 7-13/16 | 34-13/16 | 21 | 71 | 106 | 13-1/4 | 11-1/2 | 3-7/8 | 36-3/4 | 4-1/2 | 38-1/2 | 18 | 48-1/4 | |
| D150-G10 | 138-7/8 | 27-3/8 | 36-3/4 | 29-3/4 | 36-3/4 | 26-1/8 | 33 | 3-3/4 | 3-3/4 | 30-5/16 | 7-13/16 | 34-13/16 | 21 | 71 | 106 | 13-1/4 | 11-1/2 | 3-7/8 | 36-3/4 | 4-1/2 | 38-1/2 | 18 | 48-1/4 | |
| D250-G15 | 158-7/8 | 37-3/8 | 40-3/4 | 43-3/8 | 33-1/8 | 38-1/8 | 33 | 3-3/4 | 3-3/4 | 34-3/16 | 7-13/16 | 42-13/16 | 31 | 79 | 124 | 18-3/4 | 16 | 6-1/8 | 50-1/2 | 4-1/2 | 44 | 20 | 57-1/4 | |
| D150-G15 | 158-7/8 | 37-3/8 | 40-3/4 | 43-3/8 | 33-1/8 | 38-1/8 | 33 | 3-3/4 | 3-3/4 | 34-3/16 | 7-13/16 | 42-13/16 | 31 | 79 | 124 | 18-3/4 | 16 | 6-1/8 | 50-1/2 | 4-1/2 | 44 | 20 | 57-1/4 | |
| D250-G18 | 158-7/8 | 37-3/8 | 40-3/4 | 43-3/8 | 33-1/8 | 38-1/8 | 33 | 3-3/4 | 3-3/4 | 34-3/16 | 7-13/16 | 42-13/16 | 31 | 79 | 124 | 18-3/4 | 16 | 6-1/8 | 50-1/2 | 4-1/2 | 44 | 20 | 57-1/4 | |
| D150-G18 | 158-7/8 | 37-3/8 | 40-3/4 | 43-3/8 | 33-1/8 | 38-1/8 | 33 | 3-3/4 | 3-3/4 | 34-3/16 | 7-13/16 | 42-13/16 | 31 | 79 | 124 | 18-3/4 | 16 | 6-1/8 | 50-1/2 | 4-1/2 | 44 | 20 | 57-1/4 | |
| D250-G20 | 189-1/4 | 48-7/16 | 58-5/8 | 51-3/8 | 58-3/8 | 46-1/8 | 53-1/8 | 5-1/4 | 5-1/4 | 49-9/16 | 13-9/16 | 66-5/16 | 42 | 115-3/16 | 171-3/16 | 24-7/8 | 24-7/8 | 8-9/16 | 57-1/8 | 4-1/2 | 41-1/8 | 28-7/8 | 52-7/8 | |
| D150-G20 | 189-1/4 | 48-7/16 | 58-5/8 | 51-3/8 | 58-3/8 | 46-1/8 | 53-1/8 | 5-1/4 | 5-1/4 | 49-9/16 | 13-9/16 | 66-5/16 | 42 | 115-3/16 | 171-3/16 | 24-7/8 | 24-7/8 | 8-9/16 | 57-1/8 | 4-1/2 | 41-1/8 | 28-7/8 | 52-7/8 | |

| MODEL | BURNER | | | GAS PRESSURE | | | GAS CONNECTION | | | UNIT DIMENSIONS | | | CURB | | | DISCHARGE OPENING | | | WATER INLET | | | DRAIN OPENING | | |
|----------|--------|-----|------|--------------|-----------|-------|----------------|-------------|----|-----------------|-----------------|----|----------|-----------------|----|-------------------|-----------------|----|-------------|-----------------|----|---------------|-----------------|----|
| | A | B | BB | CC | D | DD | EE | FF | GG | HH | II | JJ | KK | LL | MM | NN | OO | PP | QQ | RR | SS | TT | UU | VV |
| D250-G10 | 18 | 18 | 275 | 7" VC | 1 1/4" VC | 3/4 | 895 LBS | 25"x32"x12" | 20 | 6.5 GPH | 16"x20"x2" (8) | 20 | 8.4 GPH | 20"x25"x2" (8) | 20 | 8.4 GPH | 20"x25"x2" (8) | 20 | 8.4 GPH | 20"x25"x2" (8) | 20 | 8.4 GPH | 20"x25"x2" (8) | |
| D150-G10 | 6" | 6" | 275 | 7" VC | 1 1/4" VC | 3/4 | 900 LBS | 25"x32"x12" | 20 | 6.5 GPH | 16"x20"x2" (8) | 20 | 8.4 GPH | 20"x25"x2" (8) | 20 | 8.4 GPH | 20"x25"x2" (8) | 20 | 8.4 GPH | 20"x25"x2" (8) | 20 | 8.4 GPH | 20"x25"x2" (8) | |
| D250-G15 | 12" | 18 | 550 | 7" VC | 1 1/4" VC | 1 | 1250 LBS | 30"x36"x12" | 28 | 8.4 GPH | 20"x25"x2" (8) | 28 | 8.4 GPH | 20"x25"x2" (8) | 28 | 8.4 GPH | 20"x25"x2" (8) | 28 | 8.4 GPH | 20"x25"x2" (8) | 28 | 8.4 GPH | 20"x25"x2" (8) | |
| D150-G15 | 12" | 18 | 550 | 7" VC | 1 1/4" VC | 1 | 1250 LBS | 30"x36"x12" | 28 | 8.4 GPH | 20"x25"x2" (8) | 28 | 8.4 GPH | 20"x25"x2" (8) | 28 | 8.4 GPH | 20"x25"x2" (8) | 28 | 8.4 GPH | 20"x25"x2" (8) | 28 | 8.4 GPH | 20"x25"x2" (8) | |
| D250-G18 | 12" | 18 | 825 | 7" VC | 1 1/4" VC | 1 | 1520 LBS | 38"x43"x12" | 35 | 10.5 GPH | 16"x20"x2" (15) | 35 | 10.5 GPH | 16"x20"x2" (15) | 35 | 10.5 GPH | 16"x20"x2" (15) | 35 | 10.5 GPH | 16"x20"x2" (15) | 35 | 10.5 GPH | 16"x20"x2" (15) | |
| D150-G18 | 12" | 18 | 825 | 7" VC | 1 1/4" VC | 1 | 1520 LBS | 38"x43"x12" | 35 | 10.5 GPH | 16"x20"x2" (15) | 35 | 10.5 GPH | 16"x20"x2" (15) | 35 | 10.5 GPH | 16"x20"x2" (15) | 35 | 10.5 GPH | 16"x20"x2" (15) | 35 | 10.5 GPH | 16"x20"x2" (15) | |
| D250-G20 | 24" | 366 | 1100 | 7" VC | 1 1/4" VC | 1 | 2220 LBS | 45"x54"x12" | 42 | 12.6 GPH | 20"x25"x2" (12) | 42 | 12.6 GPH | 20"x25"x2" (12) | 42 | 12.6 GPH | 20"x25"x2" (12) | 42 | 12.6 GPH | 20"x25"x2" (12) | 42 | 12.6 GPH | 20"x25"x2" (12) | |
| D150-G20 | 30" | 458 | 1375 | 7" VC | 5 PSI | 1-1/4 | 2220 LBS | 45"x54"x12" | 42 | 12.6 GPH | 20"x25"x2" (12) | 42 | 12.6 GPH | 20"x25"x2" (12) | 42 | 12.6 GPH | 20"x25"x2" (12) | 42 | 12.6 GPH | 20"x25"x2" (12) | 42 | 12.6 GPH | 20"x25"x2" (12) | |

MAX. ROOF OPENING 2" SMALLER THAN CURB OUTSIDE DIMENSION
**MAX. EVAP WATER PRESSURE = 50 PSI @ 70 DEG. F

Direct Fired (DF) Profile Plate Assembly

Direct Fired Profile Plate Specifications:

Profile plates shall be formed from G90 galvanized steel.

Profile plates shall vary in size per unit.

Profile plates shall be designed to allow for the discharge of the burner.

Profile plates shall incorporate properly torqued, permanently mounted spring hinges.

Profile plates shall be designed to ensure proper air velocity and pressure drop across the burner.

Profile plates shall allow burners to achieve clean combustion by limiting by-product levels to a maximum of 5ppm of carbon monoxide (CO), and 0.5ppm of nitrogen dioxide (NO2).

Application:

Spring-loaded burner profile plates are engineered to automatically react to the momentum of a fresh air stream, without the need for any motors or actuators to mechanically adjust them. With this feature, all DF units are designed for demand control ventilation (DCV) requirements.

General Construction:

All profile plate assemblies shall be included in the DF unit's ETL listing and comply with combined safety standards ANSI Z83.4 and CSA 3.7 (non-retracting DF heaters) and ANSI Z83.18 (retracting DF heaters).