

MODULAR INDOOR INLINE BLOWER WITH EVAPORATIVE COOLER INTAKE

CSAH1
REV#2 06/15/2015

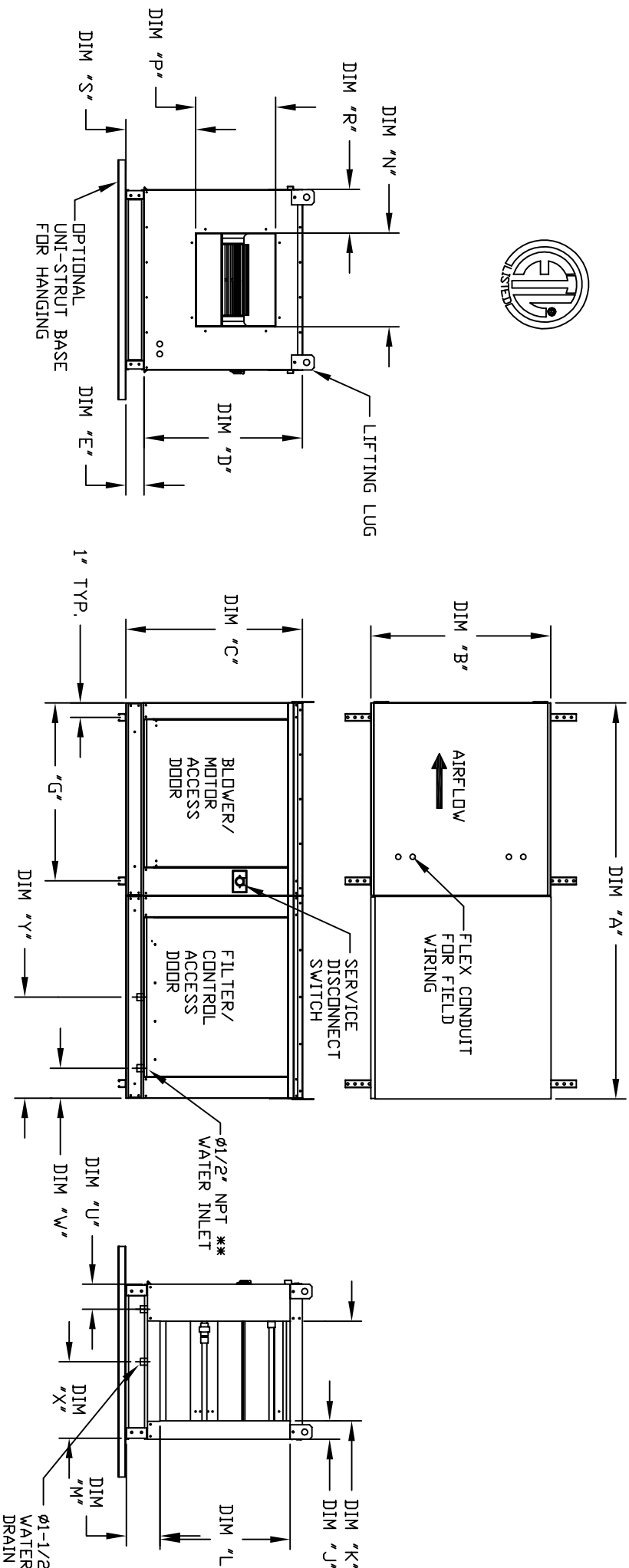

ALL DIMENSIONS ARE NOMINAL AND GIVEN IN INCHES.

MODEL	UNIT DIMENSIONS										INTAKE OPENING					DISCHARGE OPENING					WATER INLET					DRAIN OPENING				
	A	B	C	D	E	F	G	J	K	L	M	N	P	R	S	U	W	X	Y	U	W	X	Y	U	W	X	Y			
G10	64-3/8	27-3/8	29-3/4	26-1/16	3-3/4	36	31-1/8	3-1/8	16-3/4	21-7/8	5-3/4	13-1/4	11-1/2	6-3/8	11-7/8	4-1/2	6-1/4	13	16	6-1/4	13	16	6-1/4	13	16	6-1/4	13			
G12	72-3/8	37-3/8	36-3/4	33-1/16	3-3/4	48	39-1/8	5-1/8	24-3/4	28-7/8	5-3/4	15-3/4	13-9/16	10-1/8	13-1/16	4-1/2	6-1/4	18	16	6-1/4	18	16	6-1/4	18	16	6-1/4	18			
G15	72-3/8	37-3/8	36-3/4	33-1/16	3-3/4	48	39-1/8	5-1/8	24-3/4	28-7/8	5-3/4	15-3/4	13-9/16	10-1/8	13-1/16	4-1/2	6-1/4	18	16	6-1/4	18	16	6-1/4	18	16	6-1/4	18			
G18	83-3/8	41-3/8	43-3/8	38-1/16	5-1/4	60	44-1/8	4-5/8	29-1/4	33-7/8	7-1/2	22	22	9	17-7/8	4-1/2	5-3/4	20	19	5-3/4	20	19	5-3/4	20	19	5-3/4	20			
G20	99-9/16	48-7/16	51-3/8	46-1/8	5-1/4	60	63-3/16	4-5/8	36-1/4	41-7/8	7-1/2	24-7/8	24-7/8	11-1/16	19-1/8	4-1/2	5-3/4	23-1/2	17-1/2	5-3/4	23-1/2	17-1/2	5-3/4	23-1/2	17-1/2	5-3/4	23-1/2			
925	109-9/16	59-3/16	58-3/8	53-1/8	5-1/4	72	73-3/16	4-5/8	47	48-7/8	7-1/2	31-3/8	31-3/8	13-3/16	21-9/16	4-1/2	5-3/4	28-7/8	17-1/2	5-3/4	28-7/8	17-1/2	5-3/4	28-7/8	17-1/2	5-3/4	28-7/8			

UNIT INFORMATION

MODEL	STANDARD EVAPORATIVE COOLING UNIT					CELDEK EVAPORATIVE COOLING UNIT				
	TOT. WEIGHT	MEDIA SIZE & QTY	VEL. @ MAX. CFM/NOZZLES	MAX. FLOW RATE		TOT. WEIGHT	MEDIA SIZE & QTY	VEL. @ MAX. CFM/NOZZLES	MAX. FLOW RATE	
G10	335 LBS	20"x25"x2" (3)	406 FPM	6	3	340 LBS	20"x24"x12"	1050 FPM	12	3.9
G12	530 LBS	16"x20"x2" (8)	358 FPM	10	5	525 LBS	25"x32"x12"	900 FPM	20	6.5
G15	540 LBS	16"x20"x2" (8)	429 FPM	10	5	535 LBS	25"x32"x12"	1080 FPM	20	6.5
G18	675 LBS	20"x25"x2" (8)	348 FPM	14	7	665 LBS	30"x36"x12"	1067 FPM	28	8.4
G20	1065 LBS	16"x20"x2" (15)	572 FPM	24	12	1035 LBS	38"x43"x12"	1322 FPM	35	10.15
925	1510 LBS	20"x25"x2" (12)	638 FPM	30	15	1470 LBS	45"x54"x12"	1304 FPM	42	12.6

*** MAY VARY BASED UPON DIFFERENT OPTIONS - EN DCI & TN MFC C