

MODULAR OUTDOOR DOWN DISCHARGE BLOWER-ROOF TOP PACKAGE WITH V-BANK FILTER, COOLING COIL AND INTAKE HOOD

JHTLVBCDARHP  
REV#3 6/2/2009

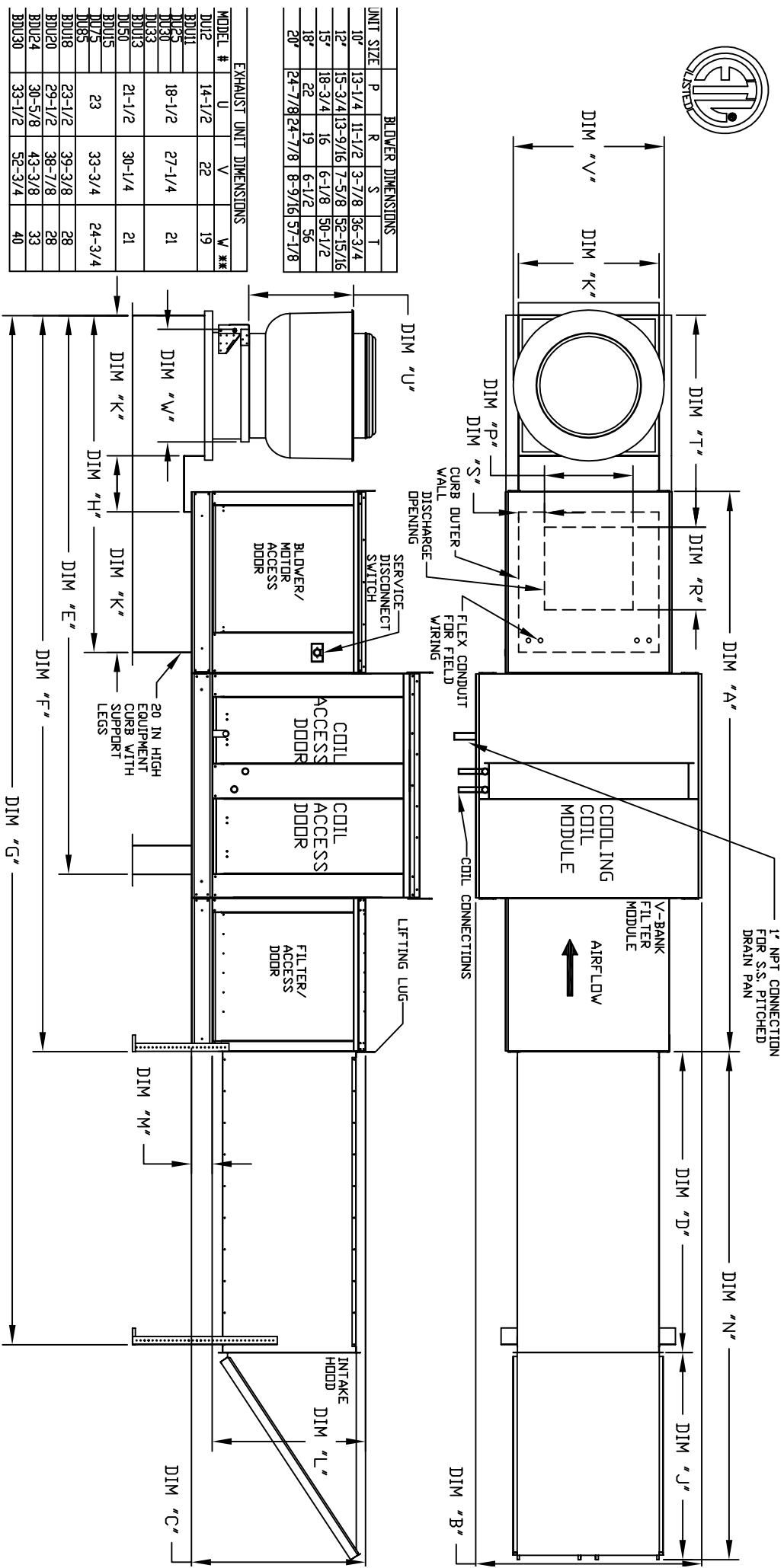

**BLOWER DIMENSIONS**

UNIT SIZE	P	R	S	T
10"	13-1/4	11-1/2	3-7/8	36-3/4
12"	15-3/4	13-9/16	7-5/8	52-15/16
15"	18-3/4	16	6-1/8	50-1/2
18"	22	19	6-1/2	56
20"	24-7/8	24-7/8	8-9/16	57-1/8

**EXHAUST UNIT DIMENSIONS**

MODEL #	U	V	V**
BDU2	14-1/2	22	19
BDU1	18-1/2	27-1/4	21
BDU3	21-1/2	30-1/4	21
BDU5	23	33-3/4	24-3/4
BDU8	23-1/2	39-3/8	28
BDU20	29-1/2	38-7/8	33
BDU24	30-5/8	43-3/8	33
BDU30	33-1/2	52-3/4	40

ALL DIMENSIONS ARE NOMINAL AND GIVEN IN INCHES

MODEL	SUPPLY UNIT DIMENSIONS					CURB AND RAIL DIMENSIONS					UNIT INFORMATION					TONAGE RANGE	
	A	B	C	D	E	F	G	H	J	K	L	M	N	Filter Size & Qty	Max. Filter Velocity	Min	Max
G10	1060	1383	106-5/8	39-3/8	42-3/4	188	100-3/16	3-1/8	39	3-3/4	132-3/8	20"x25"x2"	(3)	2500 CFM = 406 FPM	3 Ton	12.5 Ton	
G12	1360	1781	114-5/8	49-3/8	47-3/4	180	119-5/8	3-1/8	44	3-3/4	133-5/8	16"x20"x2"	(3)	3500 CFM = 358 FPM	5 Ton	20 Ton	
G15	1370	1781	114-5/8	49-3/8	47-3/4	180	119-5/8	3-1/8	44	3-3/4	133-5/8	16"x20"x2"	(3)	3500 CFM = 358 FPM	5 Ton	20 Ton	
G18	1390	1831	114-5/8	54-3/8	56-3/8	186	128-3/16	3-1/8	44	3-3/4	133-5/8	16"x20"x2"	(3)	3500 CFM = 358 FPM	5 Ton	20 Ton	
G20	1410	1831	114-5/8	54-3/8	56-3/8	186	128-3/16	3-1/8	44	3-3/4	133-5/8	16"x20"x2"	(3)	3500 CFM = 358 FPM	5 Ton	20 Ton	
G24	1470	1931	114-5/8	64-3/8	64-3/8	196	148-3/16	3-1/8	44	3-3/4	133-5/8	16"x20"x2"	(3)	3500 CFM = 358 FPM	10 Ton	23 Ton	
G30	1530	1931	114-5/8	64-3/8	64-3/8	196	148-3/16	3-1/8	44	3-3/4	133-5/8	16"x20"x2"	(3)	3500 CFM = 358 FPM	10 Ton	23 Ton	

ROOF OPENING 2" SMALLER THAN CURB DIMENSION