

MODULAR OUTDOOR SIDE DISCHARGE BLOWER WITH COOLING COIL, INTAKE HOOD AND MIXING BOX

REV#7 12/1/2016

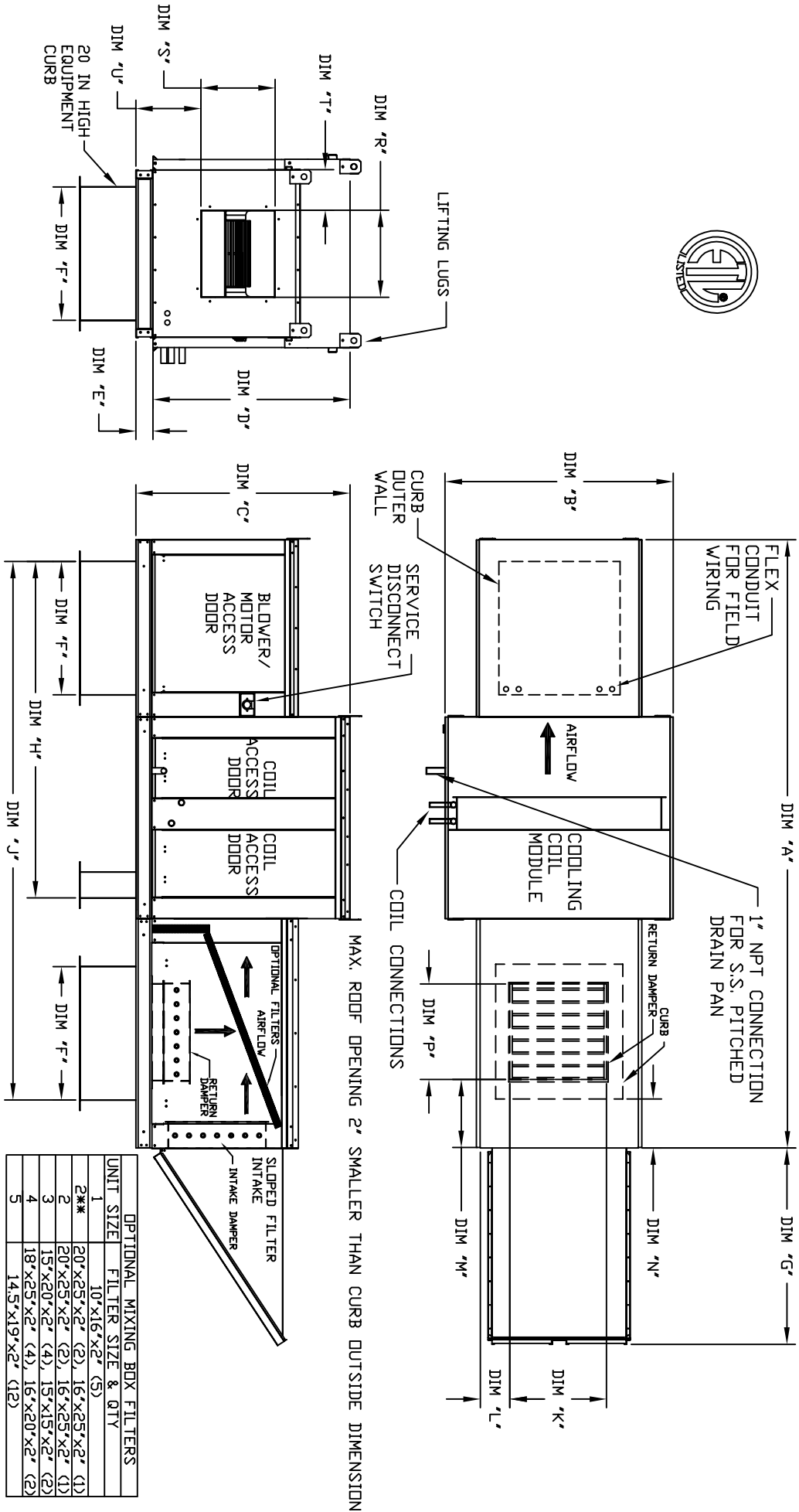

ALL DIMENSIONS ARE NOMINAL AND GIVEN IN INCHES.

UNIT SIZE	WEIGHT	A	B	C	D	E	F	G	J	H	K	L	M	N	P	R	S	T	U	R	S	T	U	MIN	MAX	
1	760 LBS	116-5/8	39-3/8	42-3/4	39	3-3/4	21	44-3/8	98-5/8	71	14	8	14	12-1/2	13-1/4	11-1/2	6-3/8	11-7/8	17-1/4	15-1/2	4-3/8	8-15/16	3	12.5	Ton	
2**	1060 LBS	124-5/8	49-3/8	47-3/4	44	3-3/4	31	53-5/8	112-9/16	76	22-3/4	8	11	7-1/2	15-3/4	13-9/16	10-1/8	13-1/16	N/A	N/A	N/A	N/A	5	20	Ton	
3	1070 LBS	124-5/8	49-3/8	47-3/4	44	3-3/4	31	53-5/8	112-9/16	76	22-3/4	8	11	7-1/2	15-3/4	13-9/16	10-1/8	13-1/16	N/A	N/A	N/A	N/A	5	20	Ton	
4	1310 LBS	129-5/8	54-3/8	56-3/8	51-1/8	5-1/4	35	51-5/8	120-1/8	78	28	8	7	4-1/2	16-3/4	16	8-5/8	14-1/16	24-3/4	22	5-5/8	10-13/16	10	25	Ton	
5	2200 LBS	172-13/16	60-7/16	64-3/8	59-1/8	5-1/4	42	76-3/8	153-15/16	106-3/16	33	10	11	8	36	24-7/8	24-7/8	11-1/16	19-1/8	30	8-9/16	16-5/8	20	40	Ton	
	2810 LBS	182-13/16	69-7/16	68-7/16	63-3/16	5-1/4	52-3/4	71-3/8	170-7/8	113-3/16	43	10	10	6-1/2	1-1/4	43	31-3/8	13-3/16	21-9/16	35-3/8	35-3/8	11-1/4	19-10/16	30	50	Ton

UNIT SIZE	FILTER SIZE & QTY	MAX. FILTER VELOCITY
1	16'x20'x2' (3)	@3500 CFM = 667 FPM
2**	20'x25'x2' (3)	@5000 CFM = 580 FPM
3	20'x25'x2' (3)	@6000 CFM = 696 FPM
4	16'x20'x2' (6)	@8000 CFM = 762 FPM
5	16'x20'x2' (10)	@15000 CFM = 857 FPM
	20'x25'x2' (8)	@20000 CFM = 957 FPM