

MODULAR INDOOR SIDE DISCHARGE BLOWER WITH V-BANK, LPD EVAPORATIVE COOLER INTAKE

REV#2 06/15/2015
VBL/PJG/SAH

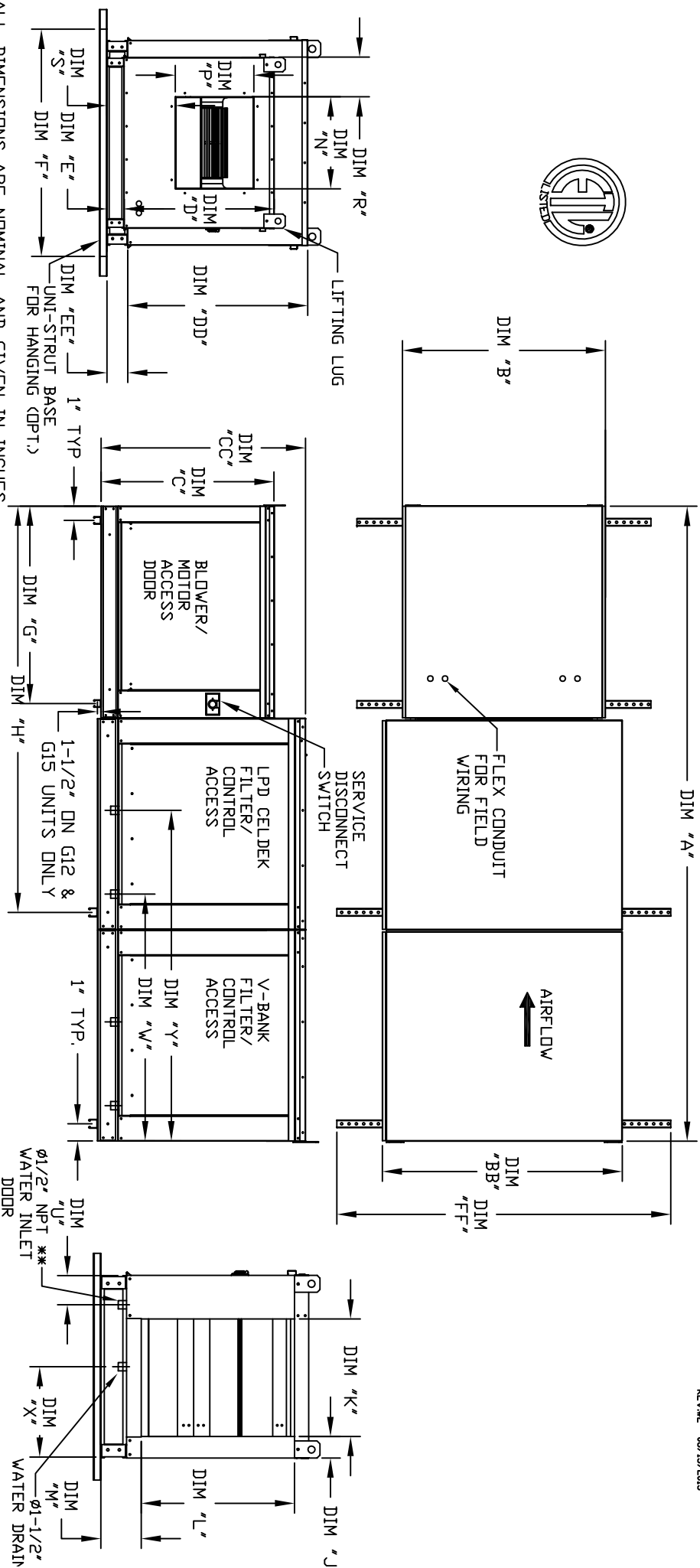

UNIT INFORMATION

MODEL	A	B	BB	CC	D	DD	E	EE	F	FF	G	H	J	K	L	M	N	N	P	R	S	
G10	96-7/16	27-3/8	36-3/4	29-3/4	36-3/4	26-1/16	33	3-3/4	3-3/4	36	48	31-1/8	63-1/4	5-1/8	24-3/4	28-7/8	5-3/4	13	1/4	11-1/2	6-3/8	11-7/8
G12	116-5/8	37-3/8	40-3/4	36-3/4	43-3/8	33-1/16	38-1/8	5-1/4	3-3/4	48	60	39-1/8	71-1/4	4-5/8	29-1/4	33-7/8	7-1/2	15-3/4	13-9/16	10-1/8	13-1/16	14-1/16
G15	116-5/8	37-3/8	40-3/4	36-3/4	43-3/8	33-1/16	38-1/8	5-1/4	3-3/4	48	60	39-1/8	71-1/4	4-5/8	29-1/4	33-7/8	7-1/2	15-3/4	13-9/16	10-1/8	13-1/16	14-1/16
G18	115-7/8	41-3/8	47-7/8	43-3/8	51-3/8	38-1/16	46-1/8	5-1/4	4	60	60	44-1/8	82-1/4	4-5/8	36-1/4	41-7/8	7-1/2	18-3/4	16	8-5/8	14-1/16	17-7/8
G20	134-15/16	48-7/16	58-5/8	51-3/8	58-3/8	46-1/8	53-1/8	5-1/4	5-1/4	60	72	63-3/16	98-7/16	4-5/8	47	48-7/8	7-1/2	24-7/8	24-7/8	11-1/16	19	19
G25	144-15/16	59-3/16	74-7/8	58-3/8	53-1/8	53-1/8	5-1/4	5-1/4	5-1/4	72	90	73-3/16	108-7/16	4-5/8	63-1/4	48-7/8	7-1/2	31-3/8	31-3/8	13-3/16	21-1/4	21-1/4

MODEL	LPD CELDEK EVAPORATIVE COOLING UNIT				WATER INLET/ DRAIN OPENING				V-BANK				
	TOT. WEIGHT	MEDIA SIZE & QTY	NOZZLES	MAX. FLOW RATE	U	V	X	Y	U	V	X	Y	FILTER SIZE & QTY
G10	515 LBS	25"x32"x12"	20	6.5 GPH	4-1/2	38-1/2	18	48-1/4	16"x20"x2"	20"x25"x2"	20"x25"x2"	20"x25"x2"	(8)
G12	745 LBS	30"x36"x12"	28	8.4 GPH	4-1/2	44	20	57-1/4	20"x25"x2"	20"x25"x2"	20"x25"x2"	(8)	
G15	755 LBS	30"x36"x12"	28	8.4 GPH	4-1/2	44	20	57-1/4	20"x25"x2"	20"x25"x2"	20"x25"x2"	(8)	
G18	970 LBS	38"x43"x12"	35	10.15 GPH	4-1/2	41-1/8	23-1/2	52-7/8	16"x20"x2"	20"x25"x2"	20"x25"x2"	(15)	
G20	1395 LBS	45"x54"x12"	42	12.6 GPH	4-1/2	41-1/8	28-7/8	52-7/8	20"x25"x2"	20"x25"x2"	20"x25"x2"	(12)	
G25	1900 LBS	45"x72"x12"	57	20.1 GPH	4-1/2	41-1/8	37-1/2	52-7/8	20"x25"x2"	20"x25"x2"	20"x25"x2"	(12)	

REV#2 MAY 15/2015 VBL/PJG/SAH